

JM Series Mechanical Diaphragm Dosing Pump

Features

- ◆ Easy installation and simple operation
- ◆ Accurate measurement and adjustable output flow
- ◆ Strong anti-corrosiveness
- ◆ Economical & practical
- ◆ Diaphragm with long-life

Application

- ◆ Reverse osmosis, electrodialysis
- ◆ Water circulation cooling
- ◆ Purification of water & sewage treatment
- ◆ Laboratory & testing room
- ◆ Other small-size measuring equipments



Model Selection & Technical Data

Model	Stroke (mm)	Stroke (in)	Flow (L/h)	Flow (GPM)	Max Pressure (PSI)	Connection (in)	Power (W)	Weight (KG)
JM-0.47/7	7	0.47	0.56	7	101.5	M18x1.5	15W	4.1
JM-1.10/7	13	1.1	1.32	7	101.5			
JM-2.36/7	25	2.36	2.83	7	101.5			
JM-3.78/7	51	3.78	4.54	7	101.5			
JM-4.72/7	51	4.72	5.66	7	101.5			
JM-10.72/4.2	70	10.72	12.86	4.2	60.9			
JM-15.77/4.2	70	15.77	18.93	4.2	60.9			

The Material of JM Pump

Part	Standard material	Optional material
Pump head	PVC	SS304, SS316
Connection parts	PVC	SS304, SS316
Valve seat	NBR	Viton, Teflon
Diaphragm	NBR	Viton, Teflon
Gasket	Teflon	
Valve Ball	Ceramic	
Discharge Tube	PE	
Suction tube	PVC	

Installation Size

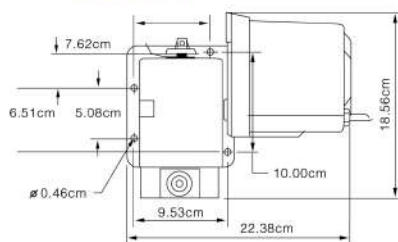

- 1.Ceramic tube
- 2.Tube
- 3.Back pressure valve
- 4.Filter valve
- 5.Tri-function valve

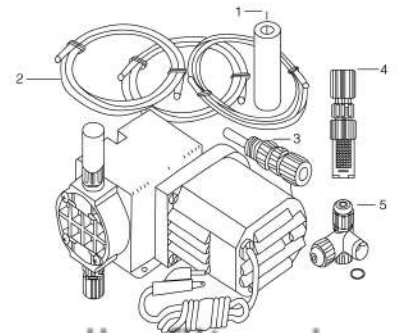

JM SYSTEM

Application

- ◆ For small water treatment or sewage water treatment

Accessories

- ◆ Tank

Constructed of high quality industrial grade polyethylene, these tanks come complete with rigid high-strength lids and feature a convenient feed hole for easy solution replenishment. Stainless steel tanks with drain holes are available.

Note: The capacity of tank less than 200L is recommend.



- ◆ Mixer (optional)

Ailipu offers a complete line of mixers to meet your needs. Each mixer is dynamically balanced on special factory equipment before it is released for shipment. Four different mounting configurations are available for your selection. Each type has strength to withstand operational stresses and each mount is protected with corrosion-resistant paint.